



Included

**Classic** Pattern Dimensions: 6'h x 16'w



Included

**Geyser** Pattern Dimensions: 14'h x 7'w



Included

**Crown & Rocket** Pattern Dimensions: Trumpet: 8'h | Crown: 4'h x 32'w



**AquaStream™**  
**1/2 HP Floating Fountain**  
 Model #ES05 Gen 3 • 5.8A, 120V/60Hz  
**Owner's Manual**



UNIT IDENTIFICATION



**Please Keep for Your Records**

## THANK YOU FOR CHOOSING THE The Pond Guy AquaStream Floating Fountain



- Easy to Install, No Tools Required
- Asynchronous Water Cooled Motor, Silicon Carbide (SiC) Shaft Bearing and Ceramic Shaft
- Energy Efficient, Fully Sealed Motor. 5.8A, 696W @ 120V, UL - Listed
- Stainless Steel Suction Screen & Body
- Engineering Grade Plastic Discharge & Nozzle Parts
- Operates in as Little as 24" of Water Depth
- Includes 3 Spray Patterns, Classic, Geyser and Crown & Rocket, Premium Nozzles Available
- Comes standard with 100' Power Cord. Available in 150', 200', 250', 300', 350' and 400' Power Cord Lengths
- Included Control Panel for Fountain & Optional Light Kits
- AquaStream 3 Year Warranty
- Control Panel 1 Year Warranty
- Provides aeration for ponds up to 1/4 acre, 6' deep. Larger ponds will require the addition of diffused air or multiple fountains

### 2. Important Safety Instructions

- Under NO circumstances should anyone enter the water with the electrical equipment plugged in and/or in operation
- **WARNING** - Risk of electric shock - This fountain is supplied with a grounding conductor and grounding-type attachment plug. To reduce the risk of electric shock, be certain that it is connected only to a properly grounded, grounding-type receptacle. This fountain has not been investigated for use in swimming pool areas.
- ALWAYS use a GFCI protected receptacle or breaker for this fountain.
- NEVER run the unit out of the water. It will damage the seals and create a dangerous situation for the operator.
- NEVER lift or drag the fountain by the power cord. Handles are provided for lifting and carrying.
- During freezing temperatures, remove fountain and store inside.
- If installing the fountain from a boat or raft ALWAYS wear a Life Guard approved personal flotation device.
- ALWAYS use a qualified electrician to install a power source next to your pond.

## CONTENTS

	Page
System Components	2A
Safety	2A
Setup & Installation	3A-4A
Maintenance & Winter Storage	4A
Troubleshooting	5A
Replacement Parts	6A

### 1. System Components



### Control Panel



### Spray Patterns

Classic, Crown & Rocket, Geyser



### Power Cord

w/strain relief cable attachment  
 100', 150', 200', 250', 300', 350' & 400'

### 3. Setup & Installation

Fig. 1

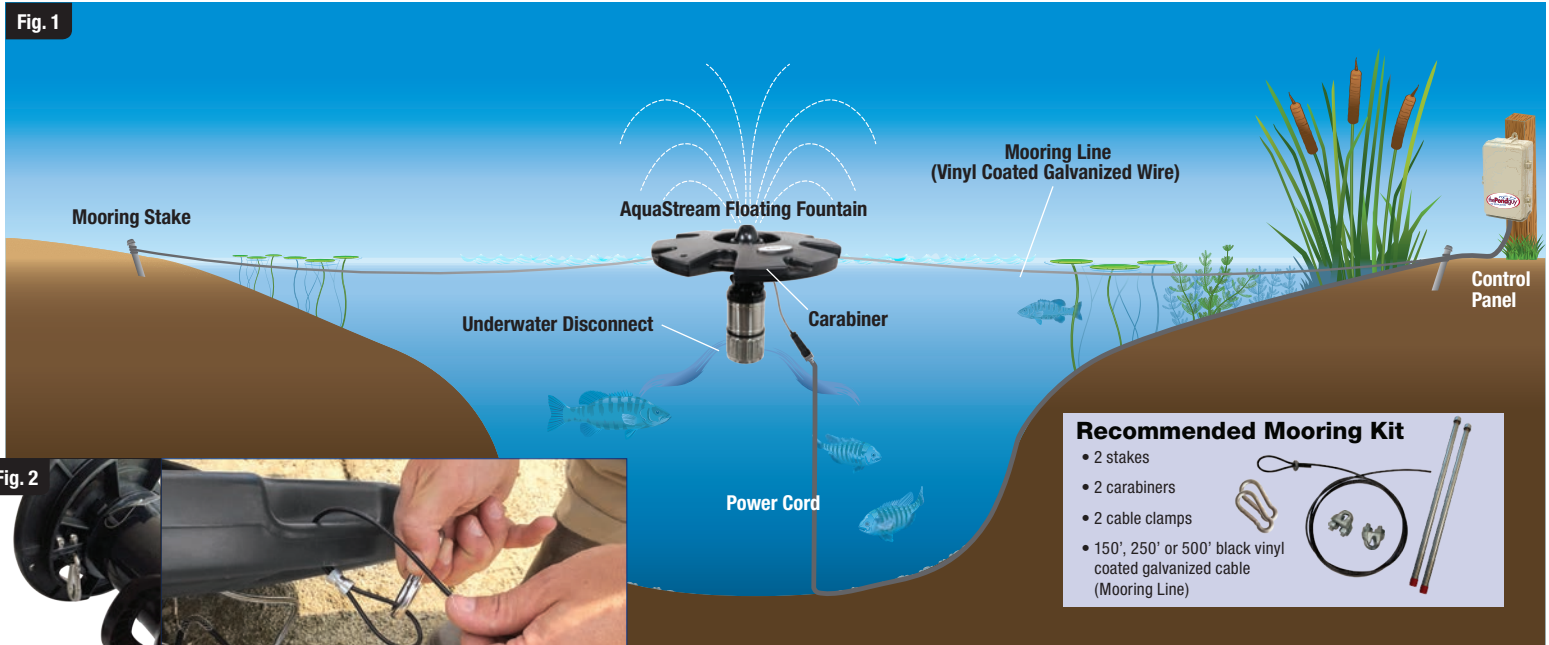

Fig. 2



Strain Relief

Mooring Kit

#### A. System Components in the Box:

1. Fountain Pump with Quick Disconnect, float mount ring and Crown & Rocket Spray Pattern (installed)
2. Float - Black
3. Power Cord
4. Control Panel
5. Classic Spray Pattern (interchangeable)
6. Geyser Spray Pattern (interchangeable)

#### Mooring Kit Options:

- #651052 – 150' Mooring Kit
- #651054 – 250' Mooring Kit
- #651055 – 500' Mooring Kit

*\* Mooring Kit Not Included with Fountain*

#### B. Prepping the AquaStream for Installation:

- 1) Ensure you have power close to your pond. If you don't, we recommend to ALWAYS use a licensed electrician to properly run power down to the pond.
- 2) Mount the Control Panel in a fixed position next to the power source.
- 3) Choose Your Spray Pattern (Fig. 3)
  - a) The AquaStream comes packaged with the Crown & Rocket spray pattern installed. However, the AquaStream includes two additional spray patterns (Geyser and Classic). Pick the one that best suits you or your special event.
  - b) To change a pattern, simply unscrew the nozzle nut, replace the pattern and reinstall the nozzle nut.
- 4) Assembling the Unit (Fig. 4)
  - a) Lay the float flat on the ground with The Pond Guy logo facing up.
  - b) Place the fountain pump assembly into the center of the float.
  - c) Lift the float straight up and ensure that the fountain pump lead power cord passes through the center hole. Gently lay the fountain to one side.
  - d) Securely attach the power cord to the fountain pump lead quick disconnect.
  - e) Attach the power cord strain relief to the loop underneath the float mount ring. (Fig. 2)
  - f) Attach a mooring cable (not included) using two outside mounting locations on opposite sides of the fountain float. (Fig. 2)

Fig. 3



Fig. 4



### 3. Setup & Installation, cont.

#### g) Installing The Pond Guy LED Fountain Light Set (sold separately) (Fig. 5)

- i) To attach the light, clip the light into the mounting spot on the float and use the vertical tension screw to secure the light into place. Continue until all lights are attached. Be mindful of the different lengths of interconnect cord between lights. The 2-light and 4-light set should be clipped into the inside mounting positions. **Note: If installing 8 lights, use small holes in float for mooring lines.**
  - ii) After attaching the The Pond Guy LED Fountain Light Set to the float, connect the power cord to the light kit quick disconnect. Adjust the lights to point to desired direction.
  - iii) Attach the light set power cord strain relief on to one of the loops underneath the float mount ring.
- h) Pick up the fountain by the float and place into the water. Note: A minimum of 24" of water is required for proper operation.**
- i) Tie one side of the mooring rope to a stake and place the stake securely into the ground.
  - j) Take the other stake and mooring rope and walk around the pond, carefully pulling the fountain across the water. Once the fountain is in position, tie the 2<sup>nd</sup> mooring rope to the 2<sup>nd</sup> stake and place securely into the ground.
  - k) Ensure both mooring ropes are snug to prevent the fountain from twisting and shifting during operation.

#### Note

Once lights are installed and clipped into position, adjust lights for desired direction.



### C. Operating the AquaStream Floating Fountain for the First Time (Fig. 6)

- 1) Plug the Control Panel into a power source.
- 2) Make sure GFCI's reset button is pushed in.
- 3) Set timer pins to desired run cycles or 24 hours.
  - a) If you are using your fountain for aeration, it is recommended to run the fountain a minimum of 10-12 hours per day, although running them longer can increase the benefits.
- 4) Plug the AquaStream Floating Fountain's power cord into the Control Panel outlet labeled "FOUNTAIN".
- 5) If the The Pond Guy LED Fountain Light Set is installed, plug the light set's power cord into the control panel outlet labeled "LIGHTS".
  - a) Minor angular adjustments may be needed to the lights to ensure the lights are illuminating the spray pattern properly.
  - b) Lights will only operate when the fountain is running and the photocell has activated the lights. **Note: Placing your control panel in a heavily shaded area or in a dark place will activate the lights continuously when the fountain is running.**

Fig. 6



### 4. Maintenance & Winter Storage

#### A. Maintenance

- 1) Disconnect ALL power from the fountain and lights before attempting any maintenance.
- 2) Periodically clean fountain intake screen of debris, algae and/or aquatic weeds.
- 3) Periodically clean light set lens with a non-abrasive brush and cleaner.
- 4) When running the fountain in dirty water or water with high mineral deposits, clean rotor every 12 months or as needed. See the **How-To Video** at [thepondguy.com/AquaStream](http://thepondguy.com/AquaStream)

#### B. Winter Removal & Storage

- 1) Remove the fountain and lights from the pond before ice begins to form.
- 2) This is the perfect time to clean or power wash any debris on the unit before storing.
- 3) It is recommended to disconnect lights from fountain and store in an area above freezing temperatures.

#### C. Spring Installation Inspection

- 1) Before re-installing the fountain and lights in the spring, check the condition of the power cord, quick disconnect connectors and replace any o-rings that may be cracked.

## 5. Troubleshooting - Fountain

### IF FOUNTAIN WON'T RUN

ISSUE	CORRECTION
GFCI Tripped	Reset GFCI
Power Cord Cut	Repair or replace power cord
Intake plugged	Clean intake
Timer not running	Verify timer is keeping time, replace timer if not
Timer trippers are not set correctly	Set on / off trippers correctly
Not enough water in reservoir	Bring water level up to at least 24" at fountain
Fountain impeller stuck	Remove fountain, clean replace impeller
Breaker tripped due to overcurrent	Reduce current load on circuit, check other equipment
Breaker tripped to GFCI	Check power cord for cuts, replace/repair

### IF NOZZLE HAS POOR QUALITY STREAMS

ISSUE	CORRECTION
Intake plugged	Clean intake
Not enough water in reservoir	Bring water level up to at least 24" at fountain
Debris caught in nozzle hole	Remove nozzle, clean, replace
Water coming over the float	Check fountain float for water, replace if any

### IF FOUNTAIN STARTS AND STOPS

ISSUE	CORRECTION
Intake plugged	Clean intake
Not enough water in reservoir	Bring water level up to at least 24" at fountain

### IF STREAMS RAISE AND LOWER

ISSUE	CORRECTION
Not enough water in reservoir	Bring water level up to at least 24" at fountain
Water coming over the float	Check fountain float for water, replace if any

### IF FOUNTAIN HUMMING - RUNNING

ISSUE	CORRECTION
Normal running	Nothing

### IF FOUNTAIN HUMMING - NOT RUNNING

ISSUE	CORRECTION
Intake plugged	Clean intake
Voltage not high enough for starting	Make sure voltage at receptacle is 120V+/-5%
Fountain impeller stuck	Remove fountain, clean replace impeller
Locked rotor	Clean rotor with a scrub brush

## 5. Troubleshooting - LED Lights

### IF ALL LIGHTS OFF

ISSUE	CORRECTION
GFCI Tripped	Reset GFCI
Power Cord Cut	Repair or replace power cord
Water in fixtures	Contact The Pond Guy for repair/replacement
Voltage not high enough for starting	Make sure voltage at receptacle is 120V+/-5%
Timer not running	Verify timer is keeping time, replace timer if not
Timer trippers are not set correctly	Set on / off trippers correctly
Photocell defective	Replace photocell

### IF ONE OR MORE (NOT ALL) LIGHTS OFF

ISSUE	CORRECTION
Water in fixtures	Contact The Pond Guy for repair/replacement
LED bulb driver failed	
LED Bulb failed	

### IF LIGHTS FLICKER

ISSUE	CORRECTION
Water in fixtures	Contact The Pond Guy for repair/replacement
Voltage not high enough for starting	Make sure voltage at receptacle is 120V+/-5%
LED bulb driver failed	Contact The Pond Guy for repair/replacement

### IF LIGHTS TURN ON AND OFF INTERMITTENTLY

ISSUE	CORRECTION
Water in fixtures	Contact The Pond Guy for repair/replacement
Photocell defective	Replace photocell
LED bulb driver failed	Contact The Pond Guy for repair/replacement

### IF LIGHTS DIM

ISSUE	CORRECTION
Voltage not high enough for starting	Make sure voltage at receptacle is 120V+/-5%
Lens might be dirty	Clean with a non-abrasive brush or cleaner

### IF ONE OR MORE (NOT ALL) LIGHTS DIM

ISSUE	CORRECTION
Water in fixtures	Contact The Pond Guy for repair/replacement
Photocell defective	Replace photocell
LED bulb driver failed	Contact The Pond Guy for repair/replacement

## 7. Replacement Parts

### Fountain Replacement Parts

1. #651310 – Nozzle Nut

#### Spray Pattern

2. #651164 – Classic Pattern (4185)
3. #651318 – Crown & Rocket Pattern (1037-iB)
4. #651320 – Geyser Pattern (1009-C)
5. #651284 – Float Mount Half Ring w/ Hardware
6. #651283 – Float Mount Ring Bolt, ¼ - 20 x ¾"
7. #651311 – Discharge Horn O-Ring

#### Pump Motor

8. #651288 – ½ HP Pump Motor w/Quick Disconnect & Discharge Horn, 120V (Complete)
  - A. #651790 – Upper Motor Mount Bolts
  - B. #652786 – Stainless Housing
  - C. #652787 – Rotor Mounting Plate
  - D. #652784 – Rotor & Impeller Assembly
  - E. #652782 – Lower Intake Housing
  - F. #651279 – Lower Intake Screw
  - G. #652781 – Stainless Suction Screen
  - H. #652783 – Suction Screen Nut
  - I. #652788 – Bearing Holder with Screen
  - J. #651791 – Rotor Locking Ring w/ Hardware

9. #651163 – Female End Cap, O-Ring

10. #651357 – Power Unit Motor Lead End Cap, Female

11. #651339 – Float

12. #651340 – Control Panel

#### Power Cord

##### 13. Power Cord Length Options

- #651378 – 100 feet, 16/3
- #651379 – 150 feet, 14/3
- #651380 – 200 feet, 14/3
- #651415 – 250 feet, 12/3
- #651416 – 300 feet, 10/3
- #651544 – 350 feet, 10/3
- #651545 – 400 feet, 10/3

14. #651356 – Power Cord End Cap, Male

15. #651060 – Strain Relief (16, 14 gauge)  
#651061 – Strain Relief (12 gauge)

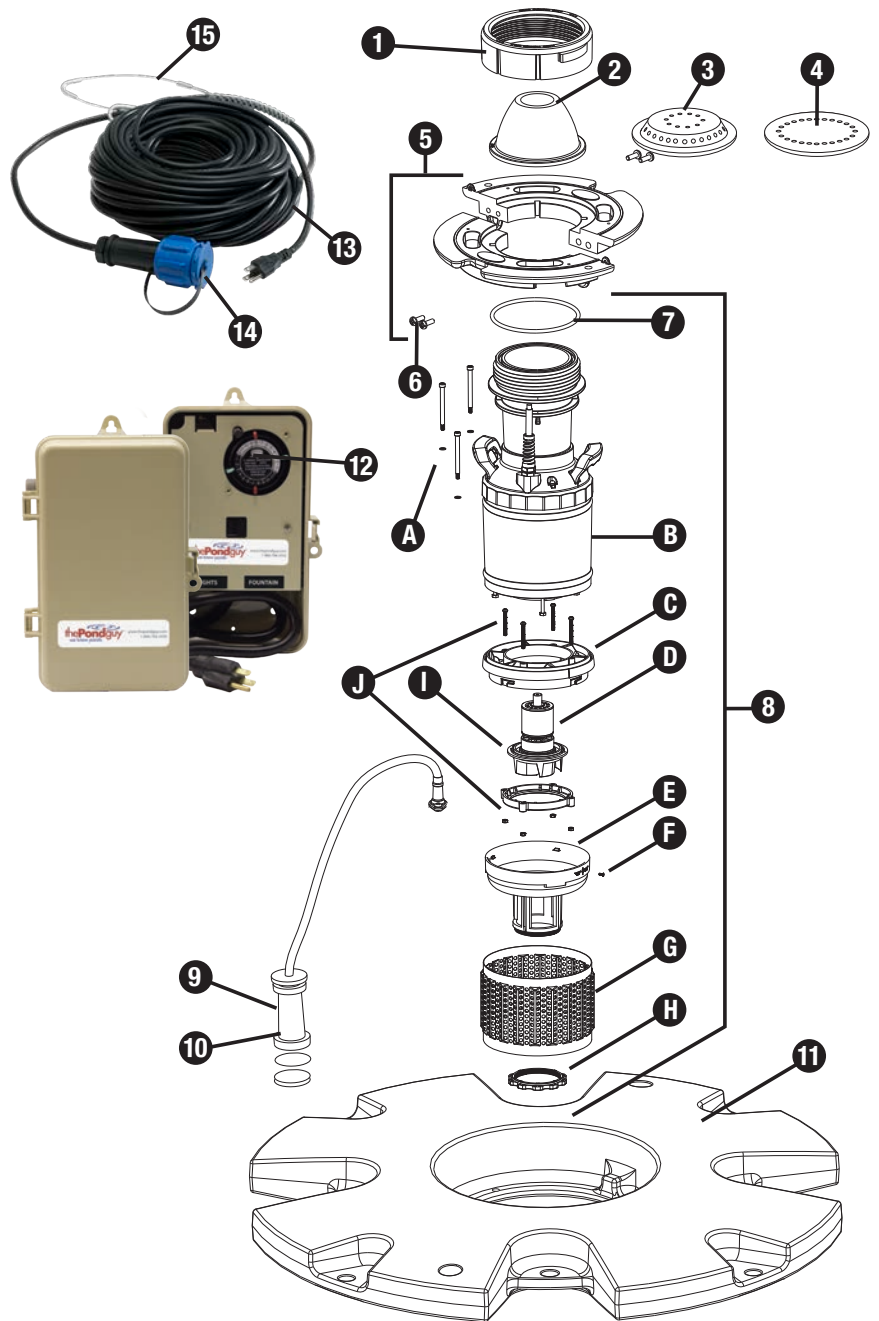

### LED Light Replacement Parts

1. #651307 – Mounting Clamp

2. #651325 – Tension Screw, ¼ - 20 x 1 ¼"

3. #651722 – Bolt, ¼ - 20 x 1 ¼"

4. #651723 – Washer, ¼"

5. #651308 – Band Clamp

#### 6. Power Cord Options

- #652646 – 100 feet, 16/3
- #652647 – 150 feet, 16/3
- #652648 – 200 feet, 16/3
- #652649 – 250 feet, 16/3
- #652667 – 300 feet, 16/3
- #652668 – 350 feet, 16/3
- #652669 – 400 feet, 16/3

7. #651060 – Strain Relief (16 gauge)
8. #651357 – Power Cord End Cap, Female
9. #651163 – Female End Cap, O-Ring

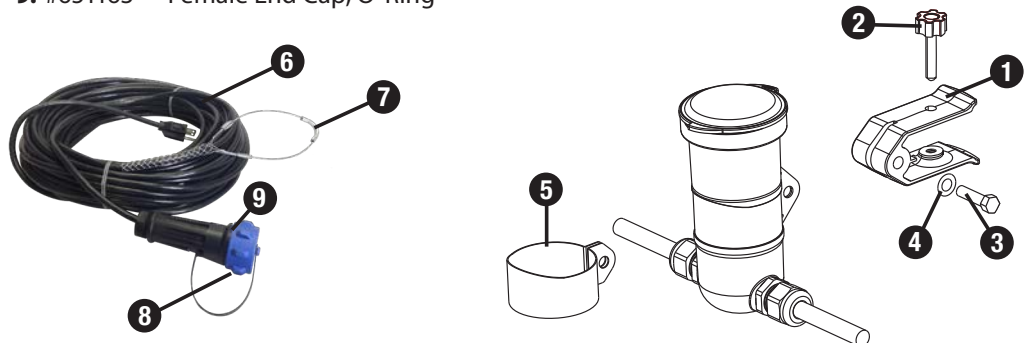

# The Pond Guy, Inc.

## The Pond Guy AquaStream Fountains

### *Limited Warranty*

---

The Pond Guy, Inc. warrants to the original purchaser (the end user) of any The Pond Guy AquaStream Fountain manufactured by The Pond Guy, Inc. that any component which proves to be defective in materials or workmanship, as determined by the factory within 3 years from the original purchased date, will be repaired or replaced at no charge with a new or remanufactured part, and returned freight prepaid. The end user shall assume all the responsibility and expense for removal, packaging, and freight to ship to The Pond Guy, Inc. to determine the warranty claim and for all reinstallation expenses. Note: AquaStream control panels are covered under a 1 year warranty.

The warranty is void in cases where damage results from: improper installation, improper electrical connection, improper voltage, alteration, lightning, careless handling, misuse, abuse, disassembly of motor or failure to follow maintenance or operating instructions. Modification or repair by an unauthorized repair facility will void the warranty.

In no case will The Pond Guy, Inc. or its distributors accept responsibility for any costs incurred by the user during installation, removal, inspection, evaluation, repair, parts replacement, or for return freight. Nor will any liability be accepted for loss of use, loss of profits, loss of goodwill, for consequential damage, or for personal injuries to the purchaser or any person.

In the event of problems believed to be covered under warranty, it will be necessary to notify The Pond Guy, Inc. for assistance. If it is concluded that there may be a defect which may be covered under warranty, you will be issued a Return Material Authorization (RMA) from The Pond Guy, Inc. prior to return shipping. Freight collect shipments will not be accepted.

The product or part(s) must be returned freight prepaid, to The Pond Guy, Inc., as directed, and in its original packaging or in a container which will prevent damage. Parts returned under warranty and damaged during shipping will not be covered under warranty for the shipping damage. If the evaluation of the returned goods concludes that the failure is due to defects in materials or workmanship, the part or parts in question will be replaced under warranty with new parts, remanufactured parts, or will be repaired; at the option of The Pond Guy, Inc. The warranty period for all parts supplied under warranty will terminate at the end of the original product's warranty. All warranty shipments from The Pond Guy, Inc. will be shipped freight prepaid.

No implied warranties of any kind are made by The Pond Guy, Inc. for its products, and no other warranties, whether expressed or implied, including implied warranties of merchantability and fitness for a particular purpose, shall apply. Should an The Pond Guy, Inc. product prove to be defective in materials or workmanship, the retail purchaser's sole remedy shall be repair or replacement of the product as expressly provided above.

The Pond Guy, Inc.  
15425 Chets Way | Armada, MI 48005  
Phone: (866) POND-HELP | (866) 766-3435  
[thepondguy.com](http://thepondguy.com)



Optional Double Arch and Geyser Pattern



Optional Double Arch Pattern



Optional Single Arch Pattern

For Information on Optional Spray Patterns,  
Visit Us Online at [thepondguy.com/aquastream](http://thepondguy.com/aquastream)

**thePondguy**<sup>®</sup>  
we know ponds™

15425 Chets Way  
Armada, MI 48005

866-POND-HELP (766-3435)  
[thepondguy.com](http://thepondguy.com)

#652315 V1